

Climax Globe Valve Grinding Machines ***for conical seats***

Model Numbers: VM2050C, VM2100C, VM2150C
Valve Seat Diameter Range: 0.4"-6.0" (10mm-150mm)



“On Site” grinding of globe valves
with conical seats

Easy to set up and handle

Powerful

High performance



CLIMAX®
Portable Machine Tools, Inc.

Climax Portable Machine Tools

2712 E. Second St.
Newberg, OR 97132 USA
Telephone: 503-538-2185
North America Toll-Free: 800-333-8311
E-Mail: info@cpmt.com
Internet: www.cpmt.com

Model VM2050C, VM2100C, VM2150C

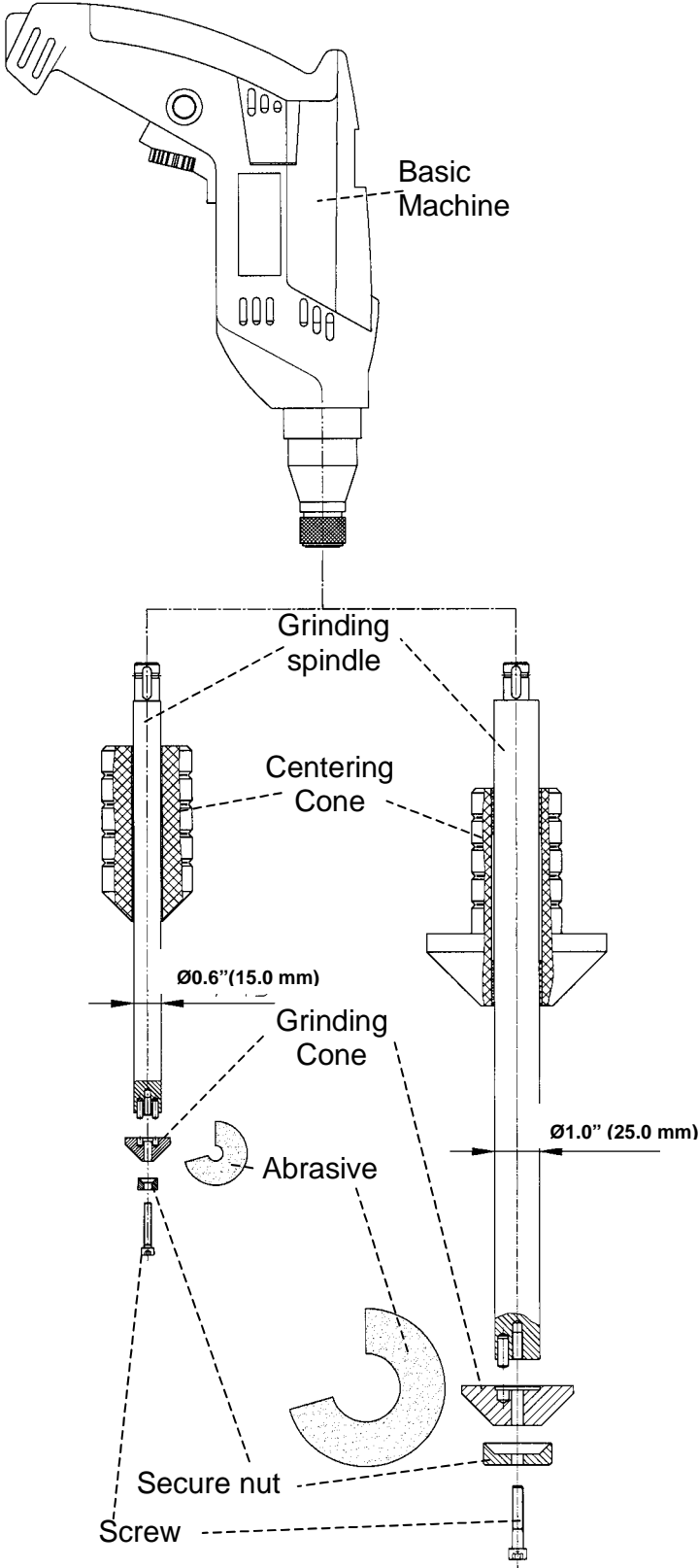

Technical Data			
Working range (Nominal Diameter)	min	0.4"	10 mm
	max (VM2050C)	2"	50 mm
	max (VM2100C)	4"	100 mm
	max (VM2150C)	6"	150 mm
Submerging depth	(VM2050C,VM2100C)	10"	250 mm
	(VM2150C)	18"	450 mm
Power	electric	0,65 kW	
	pneumatic	0,40 kW	
Variable Spindle Speed	electric (nominal load)	100 ... 450 rev/min	
	pneumatic	100 ... 650 rev/min	
Spindle Torque	permanent	5.3 ft lbs. (7.2 Nm)	
	max	29.5 ft lbs. (40.0 Nm)	



Weight		
Basic machine without tool	11 lbs	5 kg
VM2050C (for two different seat angles)		
Machine case	57 lbs	26 kg
VM2100C (for two different seat angles)		
Machine case	33 lbs	15 kg
Accessory case	57 lbs	26 kg
VM2150C (for two different seat angles)		
Machine case	33 lbs	15 kg
Accessory case	71 lbs	32 kg

Model VM2050C and VM2100C







P/N	Description
	<p>Globe Valve Grinder VM2050C basic package The basic package includes all accessories except the grinding cones and abrasives. These items have to be purchased separately depending on the seat angles. Nominal working diameter 0.4" to 2" (10 mm to 50 mm) Submerging depth 10"(250 mm). Scope of supply:</p> <ul style="list-style-type: none"> • Machine with quick change coupling to accept the grinding spindle. • Grinding spindle diameter 0.6" (15.0 mm) for grinding seats up to 0.6" (15.0 mm) diameter. Submerging depth 6"(150 mm) • Grinding spindle diameter 1.0 "(25.0 mm) for grinding seats up to 2.0" (50 mm). Submerging depth 10" (250 mm). • Centering cone for 0.6" (15.0 mm) diameter grinding spindle • Centering cone for 1.0 "(25.0 mm) diameter grinding spindle • 1 set of tooling. • Carrying cases with foam inlet for the machine and the accessories.
320-00S-L02	VM2050C with electric motor 230 V / 50 Hz
320-00S-L03	VM2050C with pneumatic motor
320-00S-L05	VM2050C with electric motor 115 V / 60 Hz
	<p>Globe Valve Grinder VM2100C basic package The basic package includes all accessories except the grinding cones and abrasives. These items have to be purchased separately depending on the seat angles. Nominal working diameter 0.4"to 4.0"(10.0 mm to 100.0 mm). Submerging depth 10"(250 mm). Scope of supply:</p> <ul style="list-style-type: none"> • Machine with quick change coupling to accept the grinding spindle. • Grinding spindle diameter 0.6" (15.0 mm) for grinding seats up to 0.6" (15.0 mm) diameter. Submerging depth 6"(150 mm) • Grinding spindle diameter 1.0 "(25.0 mm) for grinding seats up to 4.0" (100 mm). Submerging depth 10" (250 mm). • Centering cone for 0.6" (15.0 mm) diameter grinding spindle • Two centering cones for 1.0 "(25.0 mm) diameter grinding spindle • 1 set of tooling. • Carrying cases with foam inlet for the machine and the accessories.
320-00S-L12	VM2100C with electric motor 230 V / 50 Hz
320-00S-L13	VM2100C with pneumatic motor
320-00S-L15	VM2100C with electric motor 115 V / 60 Hz



Model VM2150C

P/N	Description
	<p>Globe Valve Grinder VM2150C basic package</p> <p>The basic package includes all accessories except the grinding cones and abrasives. These items have to be purchased separately depending on the seat angles.</p> <p>Nominal working diameter 0.4 " to 6" (10 mm to 150 mm) Submerging depth 450 mm (18").</p> <p>Scope of supply:</p> <ul style="list-style-type: none"> • Machine with quick change coupling to accept the grinding spindle. • Grinding spindle diameter 0.6" (15.0 mm) for grinding seats up to 0.6" (15.0 mm) diameter. Submerging depth 6"(150 mm) • Grinding spindle diameter 1.0 "(25.0 mm) for grinding seats up to 6.0" (150 mm). Submerging depth 10" (250 mm). • Grinding spindle diameter 1.0 "(25.0 mm) for grinding seats up to 6.0" (150 mm). Submerging depth 18" (450 mm). • Centering cone for 0.6" (15.0 mm) diameter grinding spindle • Two centering cones for 1.0 "(25.0 mm) diameter grinding spindle • 1 set of tooling. • Carrying cases with foam inlet for the machine and the accessories. <p>320-00S-L22 VM2150C with electric motor 230 V / 50 Hz</p> <p>320-00S-L23 VM2150C with pneumatic motor</p> <p>320-00S-L25 VM2150C with electric motor 115 V / 60 Hz</p>
	
	<p>240-13K-001 Maintenance unit for pneumatic motor</p> <p>Required for machines with pneumatic motor. The maintenance unit is not included in the standard scope of supply with pneumatic driven machines.</p> <p>Includes:</p> <ul style="list-style-type: none"> • filter • oiler • pressure gauge • speed controller

Tooling and accessories

	P/N	Description
		<p>Grinding cones for 0.4" - 2" (10 mm-50 mm) diameter seats</p> <ul style="list-style-type: none"> 7 pieces grinding cones required number of securing nuts 100 pieces abrasives Grain 120 and Grain 500 each for every dimension (total 1400 pieces) <p>320-61S-L21 Seat angle 15° (total 30°)</p> <p>320-63S-L21 Seat angle 30° (total 60°)</p> <p>320-64S-L21 Seat angle 37.5° (total 75°)</p> <p>320-65S-L21 Seat angle 45° (total 90°)</p>
		<p>Grinding cones for 2.5"- 4" (65mm- 100 mm) diameter seats</p> <ul style="list-style-type: none"> 1 grinding cone with securing nut for 2.5" (65.0 mm) diameter 2 segment grinding cones for 3.0" (80 mm) and 4.0" (100 mm) diameters 100 pieces abrasives grain 120 and grain 500 each for 2.5" (65 mm) diameter 100 pieces rectangular abrasive pads grain 120 and grain 500 each for 3.0" (80 mm) and 4.0" (100 mm) diameters <p>320-61S-L22 Seat angle 15° (total 30°)</p> <p>320-63S-L22 Seat angle 30° (total 60°)</p> <p>320-64S-L22 Seat angle 37.5° (total 75°)</p> <p>320-65S-L22 Seat angle 45° (total 90°)</p>
		<p>Grinding cones for 5"- 6"(125mm – 150mm) diameter seats</p> <ul style="list-style-type: none"> 2 segment grinding cones for 5" (125 mm) and 6" (150 mm) diameters 100 pieces rectangular abrasive pads grain 125 and grain 500 each for 5" (125 mm) and 6" (150 mm) diameters <p>320-61S-L23 Seat angle 15° (total 30°)</p> <p>320-63S-L23 Seat angle 30° (total 60°)</p> <p>320-64S-L23 Seat angle 37.5° (total 75°)</p> <p>320-65S-L23 Seat angle 45° (total 90°)</p>
	320-23S-N01	<p>Grinding Spindle for submerging depth 18"(450 mm)</p> <p>To extend the submerging depth of VM2050C or VM2100C to 18"(450 mm)</p>
	320-32S-L02	<p>Centering cone to 8" (200 mm)</p> <p>To extend the centering diameter of VM2050C or VM2100C to 8" (200 mm)</p>
	320-33S-N01	<p>3-jaw centering chuck</p> <ul style="list-style-type: none"> Centering diameter 3.2"-16.9" (80 mm to 430 mm) includes the complete chuck and a guiding bushing to accept the 1.0" (25.0 mm) grinding spindle comes in a case with foam inlet

Because CLIMAX is committed to product improvement, the machine you receive may be slightly different to the pictures above.